

GRAFITECO ^{as}



Line Clearing System

LINE CLEARING

Grafiteco has developed a new digital line clearing system for the graphical industry. The system is developed to a pocket sized computer from Datalogic called Memor that's designed to work with single hand use.

Line clearing

The line clearing system is designed to secure perfect production every time.

The system secure that each production has correct barcodes and that the barcodes is uniformed at the production line.

Wherefore the name system is called Line Clearing.

Today printers count and validate manually with no form of documentation. Grafiteco's line clearing system digitalizes this process and makes documentation simple. Printers can simply scan each product with the Memor scanner and the scanner saves logs for later use documentation.

The logs contain information about when it was scanned, the number of scanned objects and barcode reading information.

Cut maculation and complaint cots

The line clearing system is designed to secure perfect productions each time.

This helps to cut maculation cost and reduce customer complaints.

Wi-Fi and Bluetooth

Datalogic Memor is equipped with both Wi-Fi and Bluetooth connections which enables wireless data transfer direct to the production server and its work seamlessly with online verifying.

System

The line clearing system works by scanning the master code in with the handheld Datalogic Memor scanner, and by using the master code as reference.

Barcodes can by using the master code go through quality check and spot tests to secure the production. After each production scanning results are uploaded to a server and a quality and production report is generated.

Touch screen

The Datalogic Memor scanner is as user friendly as scanners come with both touch screen and keypad.

The scanner comes with a stylus pen to navigate with the touch screen, but Grafiteco's line clearing system a design to work with finger touch.



WORK FLOW

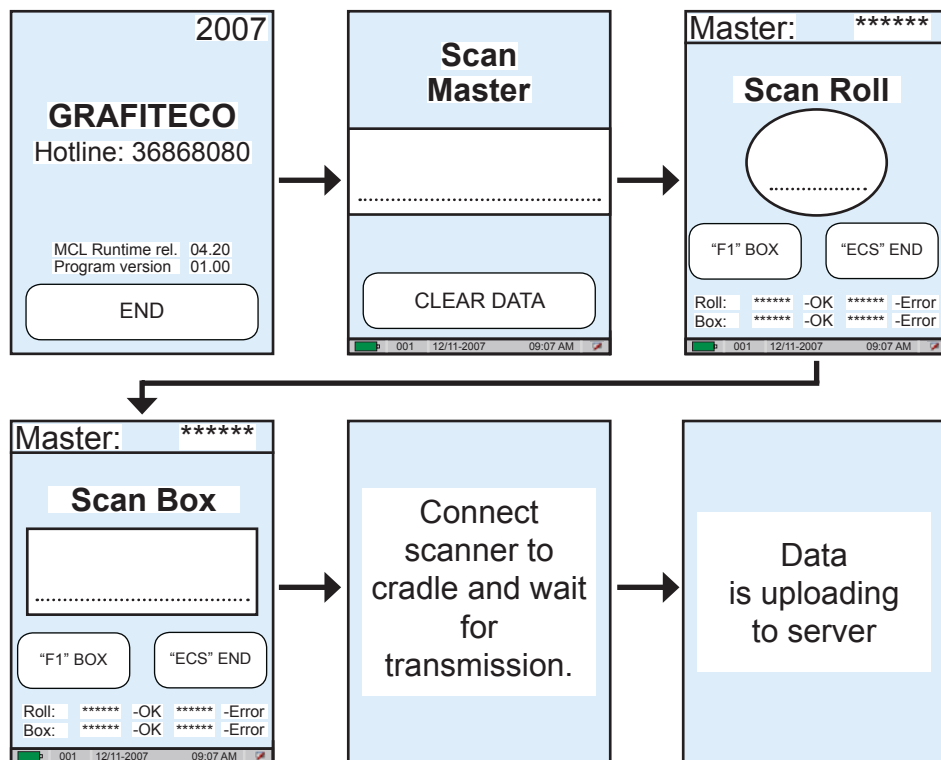

The line clearing system work flow is an easy 6 step process that guides the line manager through.

If a barcode don't match the master code or the Memor scanner has problems with data transfer a new window will guide the user through.

With Datalogic Memor™ scanner production manager can secure uniformed production and cut maculation.

PHYSICAL CHARACTERISTICS

DIMENSIONS	152 mm (5.98 in) x 55 mm (2.17 in) x 40 mm (1.57 in) (maximum)
WEIGHT	210 g (7.41 oz) incl. standard battery
DISPLAY	Reflective TFT daylight readable color display, 240 x 320 pixels diagonal
DROP RESISTANCE	Withstands drops from 1.2 meters (3.94 ft) onto concrete
WIRELESS	IEEE 802.11b/g & Bluetooth
POWER SUPPLY	Batteries and battery charger

LASER CHARACTERISTICS

SCANNING RATE	104 ± 12 scan/sec
BARCODES	EAN/UPC, Code 39, 2/5 Codes, Plessey, Codabar, Code 128, EAN128, MSI, Code 93, Code 11

SYSTEM INFO

OPERATING SYSTEM	Windows CE 5.0
MICROPROCESSOR	Intel® XScale PXA255 @ 200 MHz
SYSTEM RAM MEMORY	64 MB
SYSTEM FLASH MEMORY	128 MB (including Backup directory for user data & programs permanent storage)
EXPANSION SLOTS	Secure Digital (user accessible)
REAL-TIME CLOCK	Time and date stamping under software control

Keeping you one step ahead

Complet system	Price DKK
- Datalogic Memor Scanner - Power supply - Datalogic Cradle - MCL Client software 1. license - Datalogic USB key - Line clearing software - MCL link and serial communication Item Number Memor 60. 08 – 0001	DKK. 15.000,-
	per unit excl. VAT
Spare parts	Price DKK
Datalogic Memor scanner - Power supply Item Number Memor 60. 08 – 0002	DKK. 6.995,-
Datalogic Memor Cradle - USB data transfer Item Number Memor 60. 08 – 0003	DKK. 1.100,-
MCL Client software 1. license Item Number Memor 60. 08 – 0004	DKK. 750,-
Datalogic USB key Item Number Memor 60. 08 – 0005	DKK. 295,-
Line clearing software Item Number Memor 60. 08 – 0006	DKK. 4.000,-
MCL link and communication Item Number Memor 60. 08 – 0007	DKK. 2.100,-
Software customization Contact Grafiteco	
	per unit excl. VAT

Contact: Managing Director
Mr. Allan R. Broch
Kaergaardsvej 1
Dk-2650 Hvidovre
Denmark

Tel.: +45 36 86 80 80
Cell: +45 20 33 59 89
Fax: +45 36 77 12 44
E-mail: ab@grafiteco.dk
Homepage: www.grafiteco.dk

We reserve the right to make modifications and improvements.